

LIFT SUBS & LIFT PLUGS

A) LIFT PLUGS

ACT manufactures lifts plugs to suit various sizes O.D. drill collars. Bottom portion is threaded, the center section is bored to reduce weight. Manufactured from materials & heat treated to drill collar specifications.

B) LIFT SUBS

ACT lifts subs are manufactured from standard heat treated drill collar material specifications as per following sizes & figure.

To order or request quotations on ACT Lift Plugs, Please Specify:

1. Drill Collar O.D.
2. Drill collar connection size and Type.
3. Bore diameter, if required.

To order or request quotations on ACT Lift Subs, Please Specify:

1. Drill Collar O.D
2. Tool Joint O.D.
3. Tapered or square shoulder
4. Drill pipe O.D.
5. Drill collar connection size and Type.
6. Bore diameter, if required.
7. Pressed or cast steel thread protectors.

| LIFT PLUG DIMENSIONS | | | |
|------------------------|-----------------------|-----------------|----------------------|
| DRILL COLLAR SIZE (A") | LIFING PLATE DIA (B") | CONN. BORE (C") | APPROX. WEIGHT (lbs) |
| 3.1/2 | 5.1/2 | 1.1/2 | 35 |
| 4.1/8 | 6 | 2 | 40 |
| 4.3/4 | 6.1/2 | 2.1/4 | 50 |
| 5 | 7 | 2.1/4 | 58 |
| 6 | 8 | 2.1/4 | 82 |
| 6.1/4 | 8 | 2.1/4 | 82 |
| 6.1/2 | 8.1/2 | 2.1/4 | 90 |
| 6.3/4 | 8.1/2 | 2.1/4 | 90 |
| 7 | 9 | 2.13/16 | 100 |
| 7.1/4 | 9 | 2.13/16 | 100 |
| 8 | 10 | 2.13/16 | 128 |
| 8.1/4 | 10 | 2.13/16 | 128 |
| 9.1/2 | 11.1/2 | 2.13/16 | 165 |
| 9.3/4 | 11.1/2 | 2.13/16 | 165 |
| 11 | 13 | 2.13/16 | 245 |

| LIFT SUB DIMENSIONS | |
|---------------------|----------------------|
| TOOL JOINT O.D (A") | APPROX. WEIGHT (lbs) |
| 3.1/2 | 40 |
| 4.1/8 | 50 |
| 4.3/4 | 84 |
| 5 | 88 |
| 6 | 150 |
| 6.1/4 | 168 |
| 6.1/2 | 168 |
| 6.3/4 | 168 |
| 7 | 169 |
| 7.1/4 | 169 |
| 8 | 257 |
| 8.1/4 | 257 |
| 9.1/2 | 320 |
| 9.3/4 | 320 |
| 11 | 368 |

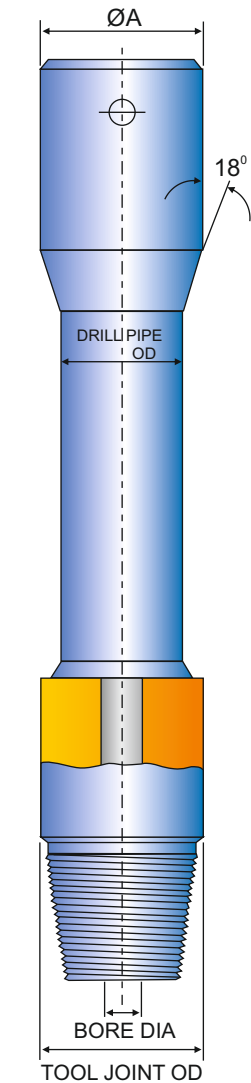

Lift Sub

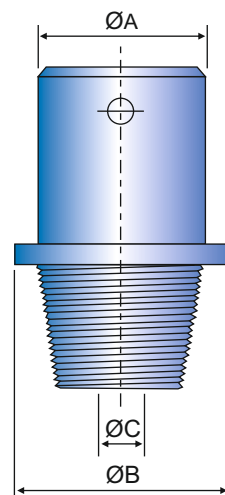

Lift Plug